

Simplicity, reliability, and performance for easy process automation

- Small footprint with a big working area
- 400mm arm length

### LS3 specifications

Arm length	400 mm	
Payload	Rated 1 kg / Max 3 kg	
Standard cycle time	0.45 sec	
Repeatability	Joint #1, #2	±0.01 mm
	Joint #4	±0.01°



### Specifications

		LS3-401*
Mounting type		Table Top
Arm length	Arm #1, #2	400 mm
Max. operating speed	Joints #1, #2	6000 mm/s
	Joint #3	1100 mm/s
	Joint #4	2600 deg/s
Weight(cables not included)		14 kg
Repeatability	Joints #1, #2	±0.01 mm
	Joint #3	±0.01 mm
	Joint #4	±0.01 deg
	Joint #1	±132 deg
Max. motion range	Joint #2	±141 deg
	Joint #3	150 mm
	(Cleanroom model)	(120 mm)
	Joint #4	±360 deg
Payload	Rated	1 kg
	Maximum	3 kg
Standard cycle time <sup>1</sup>		0.45 sec
Joint #4 allowable moment of inertia <sup>2</sup>	Rated	0.005 kg·m <sup>2</sup>
	Maximum	0.05 kg·m <sup>2</sup>
Motor power consumption	Joint #1	200 W
	Joint #2	100 W
	Joint #3	100 W
	Joint #4	100 W
Joint #3 down force		100 N
Home		Home-return-less
Installed wire for customer use		15Pin (D-Sub)
Installed pneumatic tube for customer use		Φ4mm×1, Φ6mm×2
Installation environment		Standard / Cleanroom <sup>3</sup>
Applicable Controller		RC90
Safety standard		CE compliant, ANSI/RIA15.06-1999

\*1: Cycle time based on round-trip arch motion (300mm horizontal, 25mm vertical) with 2kg payload (path coordinates optimized for maximum speed).  
 \*2: When payload center of gravity is aligned with Joint #4; if not aligned with Joint #4, set parameters using INERTIA command.  
 \*3: Complies with ISO Class 4 cleanroom standards.

[Unit: mm]

### Outer Dimensions (Table Top Mounting)

#### Standard-model

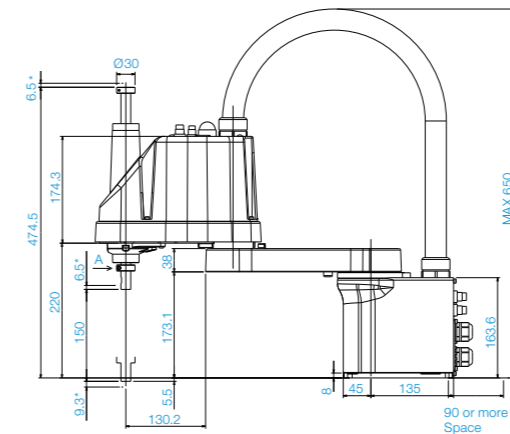
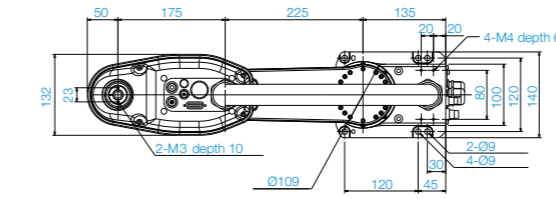

\*indicates the stroke margin by mechanical stop.

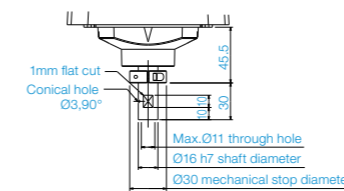
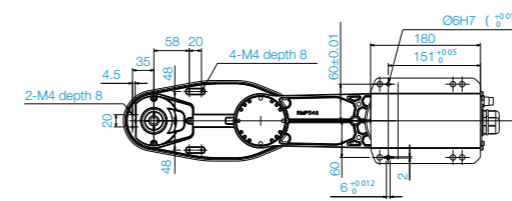

Detail of "A"

#### Cleanroom-model

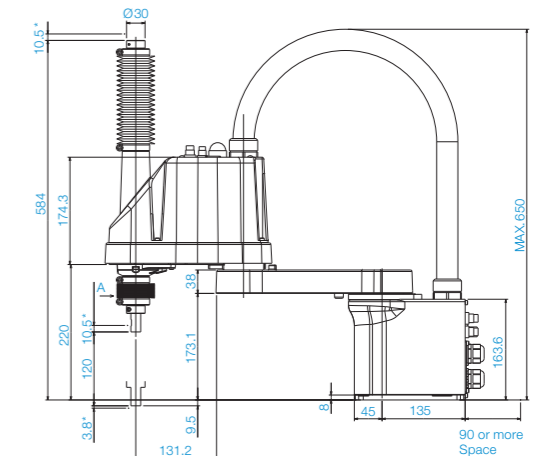
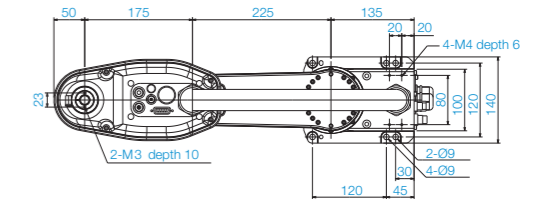

\*indicates the stroke margin by mechanical stop.

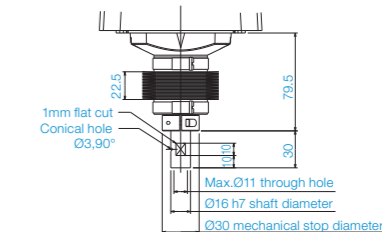
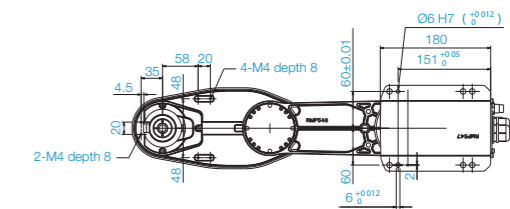

Detail of "A"

### Motion Range (Table Top Mounting)

